



**KHU53-XXX00354**

KH53

**LINEAR ENCODERS**

**SICK**  
Sensor Intelligence.



Illustration may differ



## Ordering information

Type	Part no.
KHU53-XXX00354	1030076

Other models and accessories → [www.sick.com/KH53](http://www.sick.com/KH53)

## Detailed technical data

### Interfaces

<b>Code type</b>	Universal configurable
------------------	------------------------

### Mechanical data

<b>Weight</b>	0.5 kg, per meter
<b>Length of measuring element</b>	See calculation example
<b>Read head material</b>	AlMgSi0,5F22

### Ambient data

<b>Resistance to shocks</b>	50 g, 10 ms (DIN EN 61000-2-27)
<b>Resistance to vibration</b>	30 g, 20 Hz ... 250 Hz (DIN EN 61000-2-6)

### Classifications

<b>ECl@ss 5.0</b>	27270705
<b>ECl@ss 5.1.4</b>	27270705
<b>ECl@ss 6.0</b>	27270705
<b>ECl@ss 6.2</b>	27270705
<b>ECl@ss 7.0</b>	27270705
<b>ECl@ss 8.0</b>	27270705
<b>ECl@ss 8.1</b>	27270705
<b>ECl@ss 9.0</b>	27270705
<b>ECl@ss 10.0</b>	27270705
<b>ECl@ss 11.0</b>	27270705
<b>ETIM 5.0</b>	EC002544
<b>ETIM 6.0</b>	EC002544
<b>ETIM 7.0</b>	EC002544
<b>UNSPSC 16.0901</b>	41111613

## Dimensional drawing (Dimensions in mm (inch))

### Measuring element

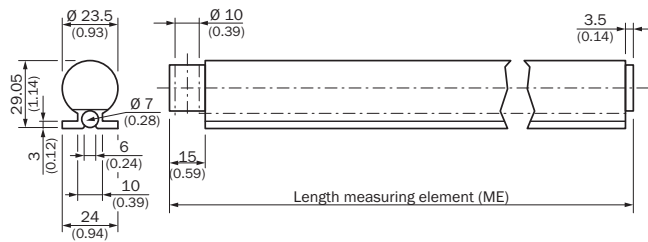

## Position tolerance

### End of measurement path

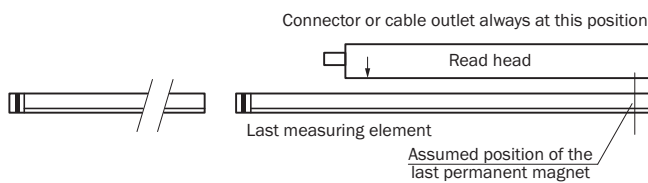

### Start of measuring path

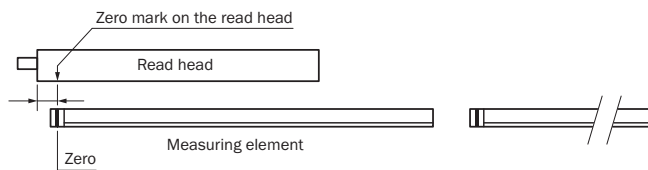

## Assembly note

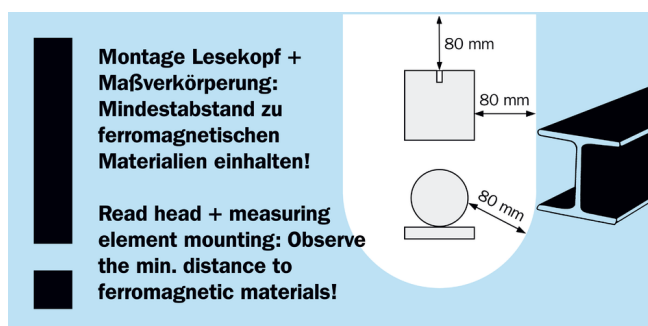

Only use non ferro-magnetic materials for the assembly base of the read head. A separation distance of 80 mm must be observed for ferro-magnetic materials (e.g., iron).

## SICK AT A GLANCE

SICK is one of the leading manufacturers of intelligent sensors and sensor solutions for industrial applications. A unique range of products and services creates the perfect basis for controlling processes securely and efficiently, protecting individuals from accidents and preventing damage to the environment.

We have extensive experience in a wide range of industries and understand their processes and requirements. With intelligent sensors, we can deliver exactly what our customers need. In application centers in Europe, Asia and North America, system solutions are tested and optimized in accordance with customer specifications. All this makes us a reliable supplier and development partner.

Comprehensive services complete our offering: SICK LifeTime Services provide support throughout the machine life cycle and ensure safety and productivity.

For us, that is “Sensor Intelligence.”

## WORLDWIDE PRESENCE:

Contacts and other locations –[www.sick.com](http://www.sick.com)